



Operational Excellence Services

Health · Safety · Environment
(HSE)

Fire and Gas Assessment



Contact Us

[Technology Inquiries](#) | [Contact Us](#) | [JGC HOLDINGS CORPORATION](#)

Access to Our Homepage

<https://www.jgc.com/en/business/epc/operation-maintenance/service/>

Fire and Gas Assessment

Do you have any of these issues?

- ☹️ **Insufficient Fire and Gas detector coverage**
- ☹️ **High Maintenance Cost of fire and gas detector**
- ☹️ **High Insurance Fee**

Fire and Gas Assessment Solution

- Evaluation of facility and gap analysis
- Identification of credible fire and gas leak hazard
- Conduct fire and gas mapping study to ensure the effectiveness
- Safety improvement by appropriate fire and gas detector placement



Gas Detector



Plant are covered by Fire and Gas Detectors



Flame Detector



Evaluation of facility

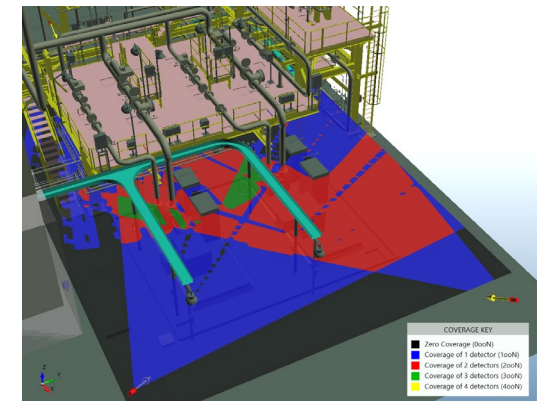

Fire and Gas Mapping Study Technology

COVERAGE KEY
Zero Coverage (00%)
Coverage of 1 detector (100%)
Coverage of 2 detectors (200%)
Coverage of 3 detectors (300%)
Coverage of 4 detectors (400%)

Fire and Gas Assessment

Workflow & Result

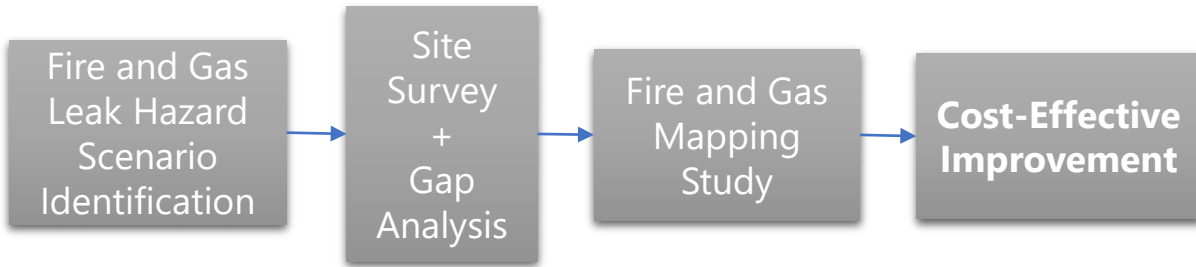

Mapping study

One of the method to analyze the effectiveness of fire and gas detector, and optimize detector location

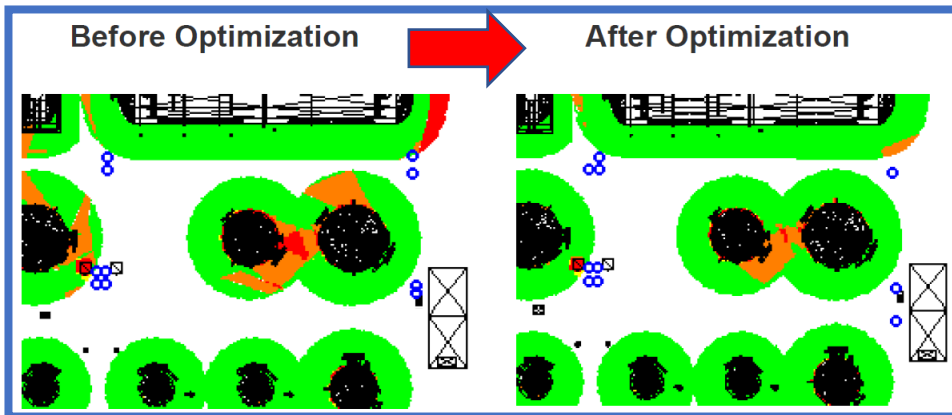

Same quantity of gas detectors --> Better coverage (wider green area)

Our Strengths

- Professional Safety, Instrument, Process and Analysis Team.
- Top global experiences of fire and gas system design and application from EPC execution
- Plant type** - Refinery, Gas Processing, LNG, Chemical
- Plant location** – Onshore, Offshore
- Client** – IOCs, NOCs
- Code and Standards** – NFPA, API, BS, etc.
- Relationship with global fire and gas detector suppliers
- Analysis software – Detect 3D(Insight numerics), Phast (DNV),

Our Experiment

20+

Mapping Study

Fire and Gas Mapping Study
Experience 20+ Study

500+

Cases

500+ Fire and Gas Design